

User Guide: OM-10

TeachLogic’s Ovation Pendant Microphone (OM-10) is a wireless mic that uses special DECT (Digital Enhanced Cordless Telecommunications) radio technology to transmit crystal clear audio throughout your classroom. With its secure connection, sleek design and simple to use features, the OM-10 is perfect for any teacher or presenter. Together with the TeachLogic Ovation amplifier/receiver (the OA-50), you can be sure every student hears you accurately and effortlessly, no matter where they are in the classroom.

DIAGRAM 1: OM-10 Controls and Features

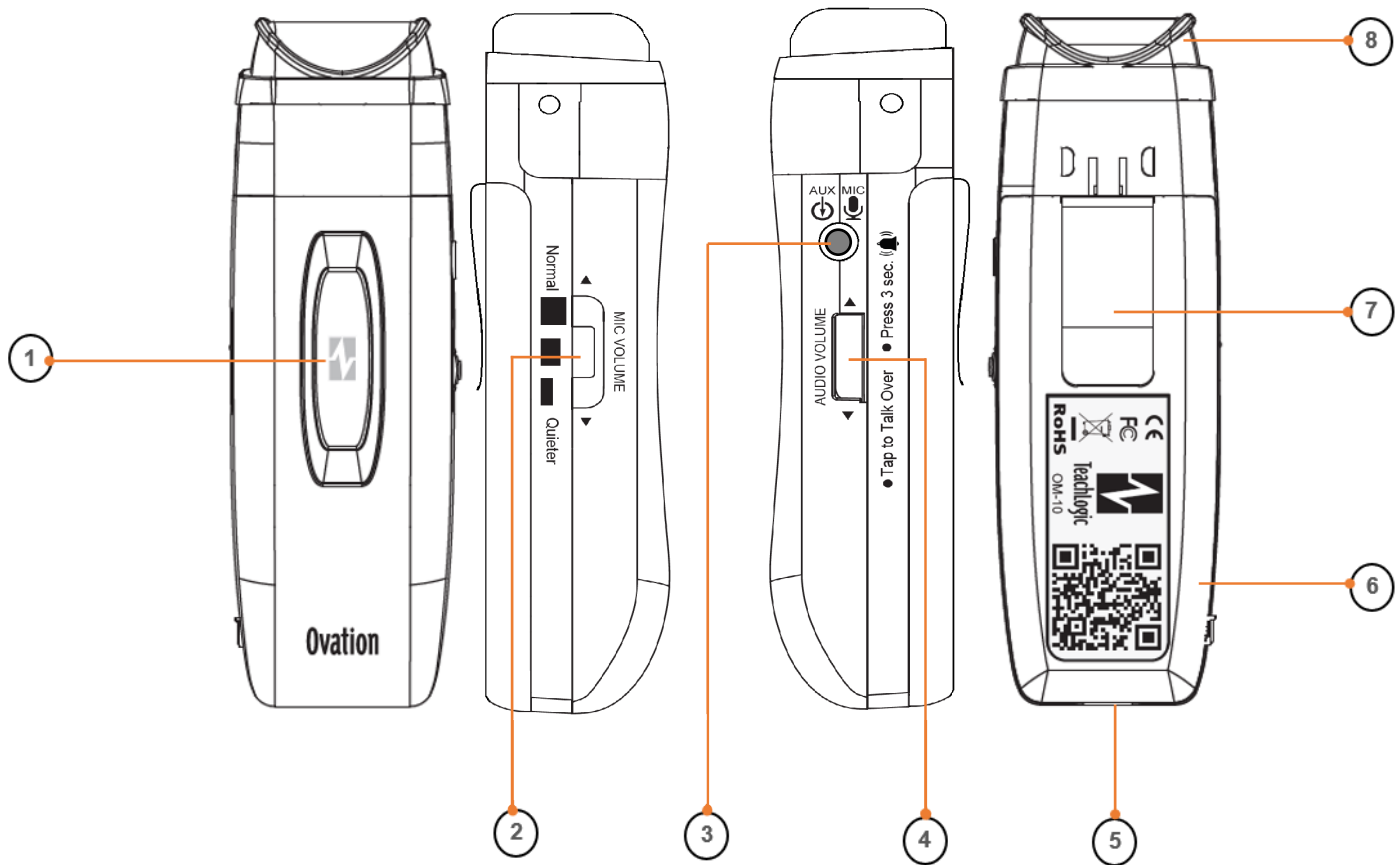

- | | |
|--|--|
| <ol style="list-style-type: none"> 1. Logo Button and Indicator Light <ul style="list-style-type: none"> • Power ON / OFF • Mute ON / OFF • Battery Level Indicator 2. Mic Volume Slide Switch 3. 3.5mm Input <ul style="list-style-type: none"> • Line Level Aux Input • External Mic Input | <ol style="list-style-type: none"> 4. Audio Spring Switch <ul style="list-style-type: none"> • Amplifier Audio Volume Control • Security Alert • Talk Over Mode 5. Micro USB Charging Port 6. Battery Cover 7. Lanyard Clip 8. Windscreen |
|--|--|

DIAGRAM 2: OC-20 Features and Indicator Lights

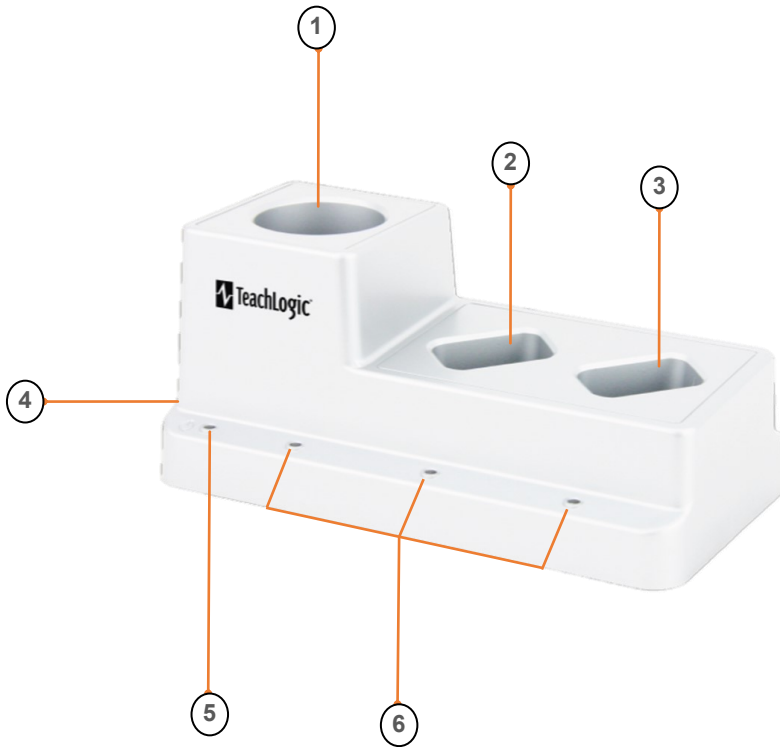

1. OC-20 USB-C Charging Dock
2. OM-10 Micro-USB Charging Dock
3. OM-10 Micro-USB Charging Dock
4. Micro-USB Power Port for OC-20
5. OC-20 Power Indicator Light
6. Charging Dock Indicator Lights

DIAGRAM 3: BRC-15 Charging Tips



- If using the TeachLogic BRC-15's micro-USB charging cable, ensure the charger is oriented correctly before you insert the cable's plug into the charging port.
- It is helpful to add a distinguishing mark on your charger plug to indicate the correct orientation for plugging it in (white side up).

DIAGRAM 4: Pairing Buttons

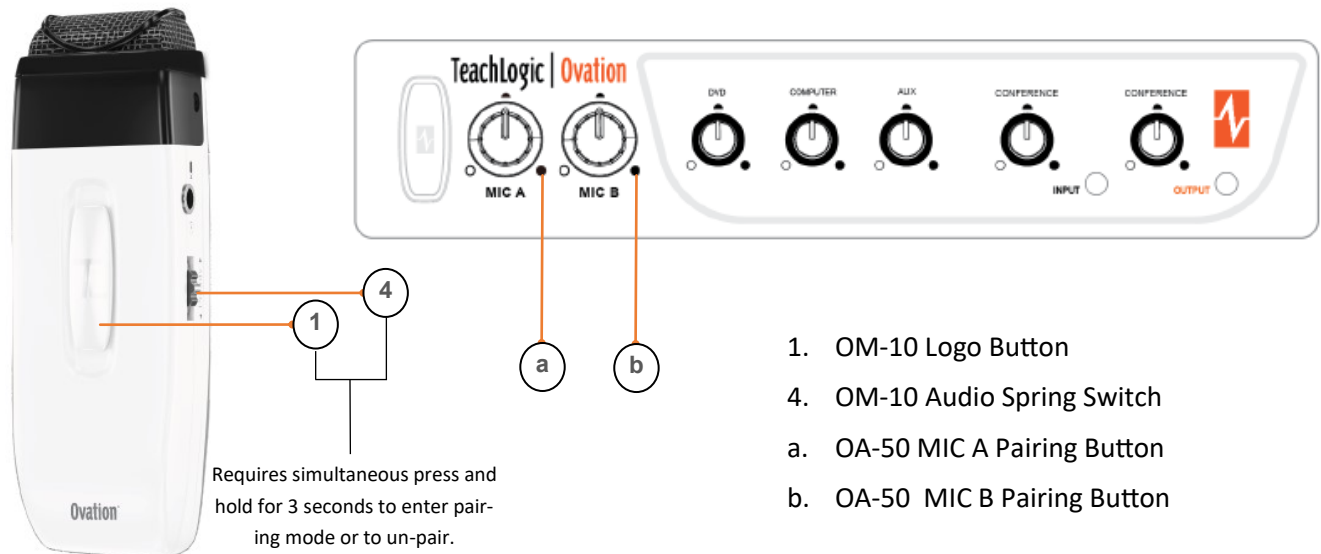

1. OM-10 Logo Button
4. OM-10 Audio Spring Switch
- a. OA-50 MIC A Pairing Button
- b. OA-50 MIC B Pairing Button

Initial Setup

How to Charge your OM-10

- ◇ **Battery Life:** The OM-10's battery life is approximately 8 hours of active use on a full charge. If your mic battery is low, it will display a solid red light when it has 10% battery life remaining. When critically low (last 5% of battery life) the red light will blink. Both indicate that it is time to charge your mic.
- ◇ **Battery Replacement:** If you notice your OM-10 is no longer holding a sufficient charge, it may be time to replace your battery. For instructions on how to replace your battery visit: <https://youtu.be/-1Rfzx96vuY>
Note: Instructions for battery replacement are the same for both the Sapphire and Ovation Microphones.
- There are two ways to charge your OM-10 mic, either use the TeachLogic Charging Stand (OC-20) or use the TeachLogic micro-USB charging block and cable (BRC-15), refer to *Diagrams 2 and 3* along with the following instructions.
 - If using the Charging Stand (OC-20), ensure your mic is facing forward and gently lower it into the charging port. Gently press down on the mic until it clicks into place and the mic logo button begins to blink green. The charging dock indicator light will slowly blink blue under the mic that is charging, indicating that the OC-20 is providing charging power to the mic.
 - It is very important to ensure that the mic is properly lined up in the charging port before exerting any "plug in" force. Very little force is needed when the mic is lined up properly. Forcing the mic into a charger when misaligned can break either the mic, the charger, or both.
 - Within a few hours, the mic will be fully charged and the logo button on the mic will be solid green to indicate this. Soon thereafter, the charger will stop providing power and the slow blinking blue light on the OC-20 charger will turn off. One hour later, the mic will power off automatically.
 - You can also charge your OM-10 with a separate micro-USB cable by inserting the cable's plug into the charging port on the bottom of your mic. If using this method, do not leave the cable plugged in for more than two days at a time or you will risk shortening your battery's life. If able, unplug it when fully charged which should take no more than six hours.
Note: The microphone will be powered on anytime it is connected to charging power, but it cannot be used to transmit audio

Pairing Mic to Receiver - MIC A or MIC B

- ◇ **What is Pairing?** Since the OM-10 is compatible with any OA-50, and there may be many in your building, it is important to associate your mic to the specific receiver in your classroom. This associating is called pairing. Pairing will tell your mic to communicate with your specific receiver and not another down the hallway.
- ◇ **Choosing the right channel:** On your OA-50, there are two channels to which you can pair your microphone, A and B. Usually, the teacher microphone will be paired as MIC A while the student microphone is paired as MIC B.
- **To pair, both mic and receiver (OA-50) will need to be in pairing mode. To do this, refer to *Diagram 4* and the below instructions.**
 - 1) Press the spring switch on the left side of your mic and the logo button at the same time and hold both for 3 seconds.
 - This will initiate the pairing mode for your microphone, and it will begin to fast-flash green. It will stay in this pairing mode for 1 minute or until paired.
 - 2) During this time, press and hold the pairing button on the OA-50 next to the MIC channel you'd like to pair with (or on the OP-10 wall panel if installed) for 3 seconds.
 - This pairing button will illuminate and start fast-flashing green indicating it has entered the pairing mode. It will stay in this pairing mode for 1 minute.
 - 3) While both units are in pairing mode, they will find each other and become paired. Once the pairing has been established, the mic logo button will turn solid blue and the OA-50 pairing button will change to solid green. Your mic is now paired and connected, ready to be used with your TeachLogic system.

Pairing vs Connecting

- Pairing your mic and receiver creates a sustained link between the two. Your mic and OA-50 will each remember its pairing even after being turned off and on. The act of pairing does not need to be repeated each time you use your mic. Each mic and receiver channel is paired to at most one other device.
- Connecting is when data transmits between the two paired devices. When connected, the two devices are communicating with each other, allowing audio to be passed through and heard. Your mic will automatically connect to your OA-50 each time they are both on.

Un-pairing your Mic

- You may wish to un-pair your mic from your receiver if you want to stop using your mic with that system. There are two methods.
 - 1) To un-pair your mic from your OA-50, press the AUDIO spring switch on the left side of your mic and the logo button at the same time and hold both for 3 seconds.
 - 2) Press the MIC A or MIC B pairing button on OA-50 and hold for 3 seconds.
- The mic logo button will turn yellow indicating it is not paired. It will stop transmitting audio. The OA-50 pair light will stop illuminating.

Using your OM-10

Essential Operating Instructions:

Setting Up your Lanyard and Positioning your Mic

- Using the clip on the back of your mic, attach your lanyard so that your mic hangs from the center point.
- Position the lanyard around your neck so the mic falls 5 in (13 cm) from your mouth, with its top resting above your collarbone.
Note: When using your mic, you will not necessarily be able to hear yourself through the speaker system. The system is meant to lift your natural volume enough so that more distant listeners hear you well. To ensure that you can be heard, and that volume levels are well adjusted, ask another person to stand in various places around the room and confirm they can clearly hear your voice.
- A plastic connector on the lanyard opens when forced and is provided to guard against choking. You may also use this to open and close the lanyard for putting it on or removing it.

Turning your Microphone On and Off

- Tap the logo button located on the front center of your mic to turn it on. Mic light will briefly flash green then turn either solid blue (if paired) or solid yellow (if unpaired).
- To pair the OM-10 microphone to an OA-50 see “*Pairing Mic to Receiver*” above.
- To turn your mic off, press and hold the logo button for 3 seconds. No lights should display when mic is off.



Muting and Unmuting your Mic

- To completely mute your mic, tap the logo button once. The mic will display a blinking blue light indicating that it is muted. No audio will be transmitted through the mic.
- To unmute your mic, tap the logo button once more. The mic will display a solid blue light once again, indicating the mic is unmuted.

Cleaning your Mic

- Periodic cleaning of the microphone is recommended to avoid the buildup of common contaminants like dust, lint, dirt, makeup, and oil. These can clog the windscreen and prevent it from working well.
- Remove dust & lint build up with a light spray of canned compressed air or a dust cloth.
- Use a disinfectant wipe to clean leftover build up that did not come off by dusting. Use extra care around the sensitive areas (charging port, windscreen, and logo button). Take care not to use a wipe with any excess liquid content that could enter the openings.
- Dry with a soft, lint-free cloth.

Reducing Volume of Non-mic Audio Inputs to the Amp using Talk Over Function

- Muting the other audio inputs temporarily “ducks down” their volume level so that your voice can be heard over them (or “Talk Over” the other audio inputs). For example, if you are playing a video from your computer over the speakers and would like to make a comment about what the students are watching, you can mute the audio from the computer, make your comment, then un-mute the audio so it returns to its previous level.
- To mute non-mic audio playing through the system, tap the AUDIO spring switch on the left side of your mic. Then the DVD, Computer, and AUX will lower in volume to allow mic users to be heard more easily. The logo button on the OA-50 will be solid purple indicating the other inputs have been muted (reduced by 20 decibels).
- To un-mute the non-mic audio, tap the AUDIO spring switch again. The non-mic audio will return to its original volume.
Exception: The conference input channel on your OA-50 will not be muted.
Note: This feature is also known as “Talk Over Mode”.

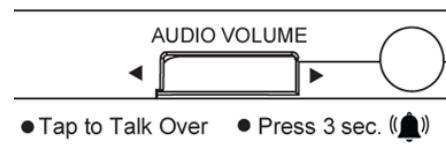

Adjusting Non-mic Audio Inputs

- The OA-50 has 4 audio inputs in addition to the 2 wireless mic channels.
- To adjust a non-mic audio input’s volume up or down, move the AUDIO spring switch on the left side of your mic by rolling up or down, respectively. All audio will start at a full standard volume and from there you can adjust the volume.
- You can hold the AUDIO spring switch in the up or down position and the volume will rise or fall 3 steps every second. Or you can tap the switch up/ down until desired volume is reached 1 step at a time. There are 20 steps from normal to quiet.

Adjusting Mic Pair Volume

- To adjust the volume of your voice through the mic, move the VOICE sliding switch on the right side of your mic up or down. There are 3 positions, upper, middle, and lower, which correspond to a mic volume of “Normal to Quieter”.

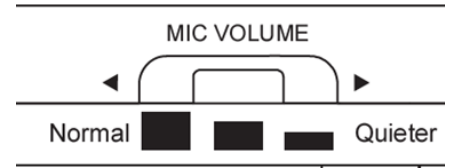

Activating the Security Alert



- To activate the security alert, press and hold the AUDIO spring switch on the left side of your mic in for 3 seconds. This will send a security alert through your OA-50. Once activated your mic will flash green 3 times indicating its successful alert.
- The security alert feature will only work if your OA-50 is connected to your school’s security system.

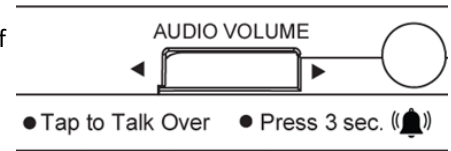

Using your Mic to Send your Smartphone’s or Tablet’s Audio to the System Speakers

- To play audio through your mic from another device, connect the two devices with an audio cable, plugging one end into the 3.5mm AUX/ MIC jack on the left side of your OM-10. Sound from the microphone element in the OM-10 will be shut off and the new input will play.



Using a Lapel Mic or Other Head Worn Microphone

- An external microphone may be used instead of the OM-10’s built in microphone element.
- Connect an “electret condensing” type of microphone to the 3.5 mm AUX/ MIC jack on the left side of the OM-10. The OM-10 provides 1.5V power as typically required of this type of microphone.
Note: A “dynamic” type of microphone is not supported.

Auto Shut Off Times

- If mic is left on while paired with no audio activity, it will auto shut off after 1 hour.
- If mic is left on while unpaired, it will auto shut off after 5 minutes.

Mic Logo Button Indicator Light Color Chart

LIGHT COLOR	DESCRIPTION
No Light	Power is OFF
Solid Yellow	ON and Unpaired
Solid Blue	ON and Connected
Fast Blinking Green	Pairing Mode
Blinking Blue	Mute
Solid Red	10% Battery Remaining
Blinking Red	5% Battery Remaining
Blinking Green (while connected to charger)	Charging
Solid Green (while connected to charger)	Charged

FCC compliance statement:

Contains Transmitter Module FCC ID: Y82-DA14AVD / IC ID: 9576A-DA14AVD

This device complies with Part 15 of the FCC Rules.

Operation is subject to the following two conditions: (1) this device may not cause harmful interference, and (2) this device must accept any interference received, including interference that may cause undesired operation of the device.

Changes or modifications to the equipment not expressly approved by the Party responsible for compliance could void the user's authority to operate the equipment.

Note: This equipment has been tested and found to comply with the limits for a Class B digital device, pursuant to part 15 of the FCC Rules. These limits are designed to provide reasonable protection against harmful interference in a residential installation. This equipment generates, uses and can radiate radio frequency energy and, if not installed and used in accordance with the instructions, may cause harmful interference to radio communications. However, there is no guarantee that interference will not occur in a particular installation. If this equipment does cause harmful interference to radio or television reception, which can be determined by turning the equipment off and on, the user is encouraged to try to correct the interference by one or more of the following measures:

- Reorient or relocate the receiving antenna.
- Increase the separation between the equipment and receiver.
- Connect the equipment into an outlet on a circuit different from that to which the receiver is connected.
- Consult the dealer or an experienced radio/TV technician for help.
- Privacy of communications may not be ensured when using this device.

